



# 1-800-BOLLARDS

The Bollard Experts

SELECT DESIRED MATERIAL:

- FDMSSM50 STAINLESS STEEL F2656-20 M50 \*eng
- FDMCSM50 CARBON STEEL F2656-20 M50 \*eng

SELECT DESIRED STAINLESS STEEL BOLLARD FINISH:

- POLISHED #4 FINISH
- AS SPECIFIED \_\_\_\_\_

SELECT DESIRED CARBON STEEL BOLLARD FINISH:

- POWDER COAT RAL # \_\_\_\_\_
- AS SPECIFIED \_\_\_\_\_

SELECT DESIRED STAINLESS STEEL BOLLARD MATERIAL:

- TYPE 304
- TYPE 316

SELECT DESIRED BOLLARD CAP STYLE:

-  DOME
-  FLAT
-  REVEAL
-  SLOPED

| REVISIONS |             |      |     |
|-----------|-------------|------|-----|
| LTR       | DESCRIPTION | DATE | APP |
|           |             |      |     |
|           |             |      |     |
|           |             |      |     |
|           |             |      |     |
|           |             |      |     |
|           |             |      |     |
|           |             |      |     |
|           |             |      |     |
|           |             |      |     |

**SPECIFICATIONS**  
 HEIGHT: 48"  
 DIAMETER: 10.75"  
 WALL THICKNESS: .844"

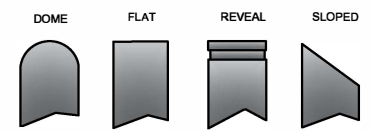
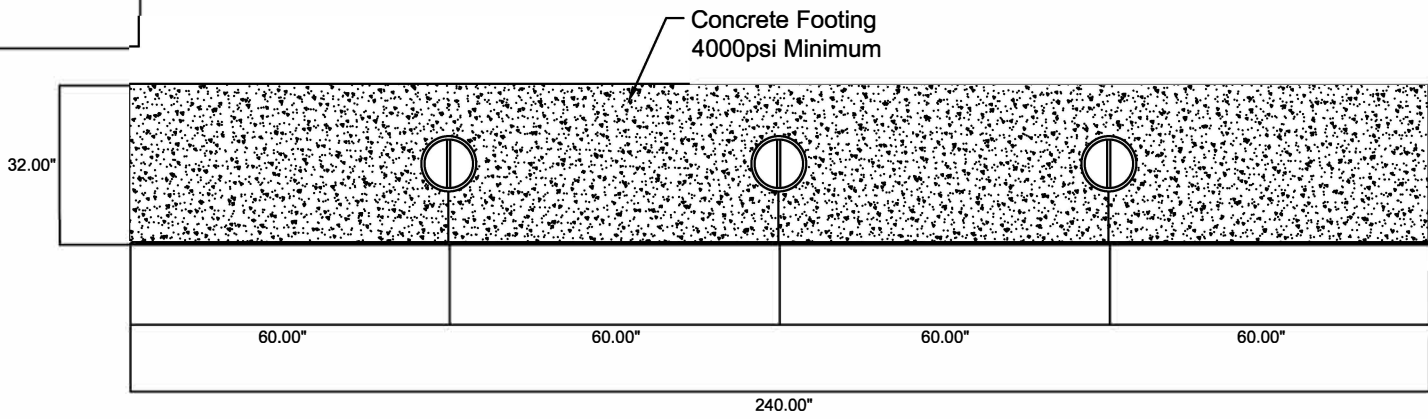

**NOTES:**  
 1. INSTALLATION TO BE COMPLETED IN ACCORDANCE WITH MANUFACTURER'S SPECIFICATIONS.  
 2. DO NOT SCALE DRAWING.  
 3. THIS DRAWING IS INTENDED FOR USE BY ARCHITECTS, ENGINEERS, CONTRACTORS, CONSULTANTS AND DESIGN PROFESSIONALS FOR PLANNING AND INSTALLATION PURPOSES.  
 4. ALL INFORMATION CONTAINED HEREIN WAS CURRENT AT THE TIME OF DEVELOPMENT BUT MUST BE REVIEWED AND APPROVED BY THE PRODUCT MANUFACTURER TO BE CONSIDERED ACCURATE.

| APPLICATION |         | ORDER NUMBER             | CASE CODE | REV | DRAWING NUMBER     |
|-------------|---------|--------------------------|-----------|-----|--------------------|
| NEXT ASSY   | LINK ON | 1-800-BOLLARDS, Inc.     | M50       | 8   | M50DMF             |
|             |         | 10 Hughes Drive ASSD     |           |     |                    |
|             |         | Irwin, CA 94605          |           |     |                    |
|             |         | PHONE: 1-800-BOLLARDS    |           |     |                    |
|             |         | FAX: 916-937-1100        |           |     |                    |
|             |         | WWW: WWW.BOLLARDS.COM    |           |     |                    |
|             |         | EMAIL: INFO@BOLLARDS.COM |           |     |                    |
|             |         |                          |           |     | BOLLARD, M50 FIXED |

